



PICKERSGILL
Retirement \ Community



PICKERSGILL



1980 1990 2000 2010 2018...

Transformation

2018 Annual Report { FY2017 }

Mission Statement



*Rendering of proposed
Nursing & Living Area*

Pickersgill is a nonprofit retirement community with a strong heritage of benevolent purpose. Begun in 1802 by a small group of caring women, Pickersgill is dedicated to helping each person achieve, with dignity, the proper balance between independence and assistance. We take pride in our blend of traditional values with contemporary living. We provide a comfortable home and high-quality care at a reasonable cost, and promote each resident's vitality of spirit.



Pickersgill Retirement Community 2017 Board of Directors

*Mrs. Karen Auwaerter
Mrs. Carlyle Barton, Jr.
Mrs. G. Wayne Berry
Mrs. Brian W. Brooke
Ms. Jana Corn Burch
Mrs. Marsha Carroll*

*Mrs. Gordon Croft
Mrs. Dennis Finnegan
Mrs. Robert W. Flower
Mrs. Jane S. Heill
Mrs. Ellen Hennessey
Mrs. Jean R. Lillquist*

*Mrs. Carol Long Mackay
Mrs. William A. Mangels
Mrs. Sandra Ortwein
Mrs. Russell P. Rich
Mrs. Jack Smith
Mrs. Stephen Tully, President*

Trans·formation

What a fitting word to describe the past year at Pickersgill.

From its initial establishment in 1802, the oldest institution of its kind in our country, Pickersgill Retirement Community has continually transformed itself throughout the years to meet the changing needs of our residents.

Last year we not only completed a new rehabilitation center that was doubled in size, we embarked on a multi-year community design plan that will transform the majority of our interior spaces as well as add new amenities such as a wellness center and additional activity spaces for our residents to enjoy. This ambitious project was started with the sole purpose of improving the quality of life of our residents. Throughout all of these changes, we're proud that we have never wavered from the core of our mission: providing a comfortable home and high-quality care for residents at a reasonable cost.

Our commitment to enhancing the lives of our residents started more than two centuries ago in 1802, when a small group of ladies built the foundation for what is now Pickersgill Retirement Community. Those remarkable ladies would be amazed to see how Pickersgill has changed over time and helped to transform the lives of thousands of residents.

We are grateful for all that is made possible through the donation of resources, both time and money, by the generous people who make up the Pickersgill family: the residents who call Pickersgill home, their friends and family members, our board, our exceptional staff, our resolute volunteers and our dedicated community sponsors. Thank you for your continued support and love of our residents.

"We're proud that we have never wavered from the core of our mission: providing a comfortable home and high-quality care for residents at a reasonable cost."



Faye Tully
President, Board of Directors



Barry Eisenberg
Executive Director

Financial Highlights

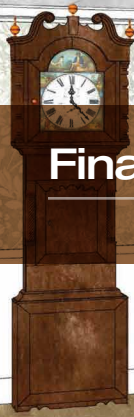

Rendering of proposed
Home Lobby

OPERATIONAL REVENUE BY SOURCE

● Resident fees	13,213,177
● Contributions and Bequests	54,382
● Gains on Investments	798,671
● Other	26,968

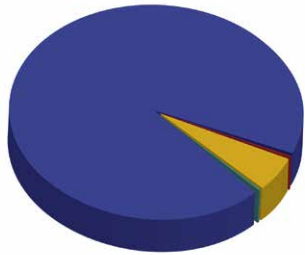

2017 INVESTMENT COMMITTEE

Robert W. Bogue, *Chairman*
 Monica Hausner
 Robert C. Lewis
 R. Taylor McLean
 Michael A. Meredith
 Wilma Zimmerman

ASSETS

CURRENT ASSETS

Cash and cash equivalents	\$5,953,893	\$4,419,696
Short term investments	1,998,231	1,273,594
Accounts receivable- net	500,140	359,428
Accrued investment income	139,961	147,662
Prepaid expenses	231,345	205,858
Other current assets	3,636	18,430
Total current assets	<u>8,827,206</u>	<u>6,424,668</u>

PROPERTY, PLANT AND EQUIPMENT- NET

	28,424,367	28,909,162
--	------------	------------

OTHER ASSETS

Investments	66,434,989	57,953,149
Resident fund reserves	282,832	261,827
Deposits	209,801	204,658
Total other assets	<u>66,927,622</u>	<u>58,419,634</u>

TOTAL ASSETS

	<u>\$104,179,195</u>	<u>\$93,743,464</u>
--	----------------------	---------------------

LIABILITIES & NET ASSETS

CURRENT LIABILITIES

Accounts payable	\$641,321	\$549,331
Accrued expenses	364,443	277,790
Current portion of long-term debt	1,190,000	1,150,000
Total current liabilities	<u>2,195,764</u>	<u>1,977,121</u>

LONG-TERM LIABILITIES

Long-term debt, net of current portion	23,170,419	24,279,711
Derivative financial instrument	3,394,517	3,877,151
Security deposits	300,897	276,616
Long-term liabilities	26,865,923	28,433,478
Total liabilities	<u>29,061,687</u>	<u>30,410,599</u>

NET ASSETS

Unrestricted	75,100,978	63,325,054
Temporarily restricted	16,530	17,811
Total net assets	<u>75,117,508</u>	<u>63,342,865</u>

TOTAL LIABILITIES AND NET ASSETS

	<u>\$104,179,195</u>	<u>\$93,753,464</u>
--	----------------------	---------------------

A Report from Pickersgill Retirement Community **Apartment Residents' Association**

The purpose of the Residents' Association is to enhance the welfare of the apartment residents by promoting ways to make their lives more interesting, enjoyable, and beneficial.

The Association encourages fellowship and participation in all cultural, recreational, religious, and social programs. Association officers also meet regularly with Pickersgill's Executive Director and staff, as well as with members of the Pickersgill Board.

The following Association activities were recorded during 2017:

- Residents continued a scholarship fund to benefit Pickersgill employees.
- Invited "Behind the Scene" employees to speak at monthly meetings.
- Held a Halloween party for children of employees.
- Donated \$150 to the Benevolent Care Fund in memory of deceased residents.
- Donated \$100 to the Activities Department by the Bingo Group.
- Continued quarterly meeting with Executive Director to give facility satisfaction feedback.
- Purchased and planted hydrangeas throughout the property.
- Wellness committee continues to expand its programming for residents.



From left to right: Bobbie Trammell, Mary Lou Fish, Elinore Davidson, Jane Seipp and Nancy Campbell

Members of the Apartment Residents' Association regularly volunteer to maintain the library, plants, and clocks; staff the convenience store; and assist with religious services, social hours, games, and programs. We are all indebted to the many Association volunteers and the ladies of the Board of Directors who give so generously of their time.

Elinore Davidson
*President, Pickersgill Apartment Residents'
Association 2017*

Special Thanks to Our Volunteers

Rendering of proposed
Suite Conversion



Pickersgill Retirement Community is enormously grateful to its volunteers. From visiting with pets to helping residents get to various activities, our volunteers selflessly give their time and talents to enhance the quality of life for Pickersgill residents.

Mrs. Karen Auwaerter
Jean Baker
Mrs. Mary Barton
Katee Bear
Ms. Christina Beltran
Mrs. Rosemary Berry
Mr. Jim Bjorkholm
Ms. Pat Blake
Mrs. Rose Bloomberg
Ms. Peggy Bonner
Mrs. Ann Brooke
Ms. Beulah Brown
Jana Corn Burch
Mr. Don Campbell
Mrs. Nancy Campbell
Dickey Canelos
Ms. Marsha Carroll
Ms. Sally Cartwright
Mrs. Anne Caskey
Mr. Wayne Caskey
Ms. Joanne Chamberlin
Mrs. Emma Chatham

Mrs. Joyce Cohen
Mrs. Rhonda Cohen
Mrs. Jane Croft
Mrs. Ann Cromwell
Ms. Catherine Cronin
Mr. Edmund Cronin
Mrs. Lenore D'Adamo
Mr. Jack Danz
Ms. Tina Darrell
Mrs. Elinore Davidson
Mr. Dick Davidson
Mr. Stephen DeRita
Dr. Bob Duval
Mrs. Peggy Eck
Ms. Mary Ellen Ensor
Mrs. Lois Evans
Mr. Richard Evans
Mr. John Famini
Mrs. Christine Ferciot
Mrs. Fran Finnegan
Ms. Mary Lou Fish
Mrs. Dorothy Flannery

Mrs. Nancy Flower
Mrs. Mary Forrester
Mrs. Elaine Gehris
Mrs. Rosemary Giovannoni
Mrs. Henni Hagner
Mrs. Mary Jane Hall
Ms. Jeanne Hansen
Ms. Ann Harper
Ms. Dorothy Hasson
Mr. Al Hayes
Mrs. Margaret Hayes
Ms. Nancy Heese
Mrs. Jane Heill
Mrs. Sunny Hendley
Mrs. Ellen Hennessey
Ms. Brigitte Henning
Mrs. Audrey Herzog
Mrs. JoAnne Holback
Ms. Mary Holland
Mrs. Pat Hoopes
Ms. Dorothy Hopkins
Mrs. Jane Hoyt

Mr. William Hoyt
Mrs. Susie Hunter
Mr. William Hunter
Mr. Paul Iliff
Mr. Bud Ivey
Ms. Michele Jackson
Ms. Reada Jasper
Mr. BJ Johnson
Ms. Cheryl Karcher
Mr. Fred Katz
Helen Kemp
Ms. Bea Kennedy
Mrs. Shirley Knode
Mr. Bob Knowles
Mrs. Bonnie Kramer
Ms. Lynn Lehneis
Mrs. Judy Lichty
Mrs. Jean Lillquist
Mrs. Tara Lily
Mrs. Carol Long Mackay
Mrs. Ann Mangels
Mr. Bill Mangels

Mrs. Jean McClary
 Ms. Marilyn Melton
 Ms. Renate Milewich
 Ms. Patty Mochel
 Mrs. Virginia Modjesky
 Mr. John Moore
 Mrs. Jean Moore
 Mrs. Lucy Moore
 Ms. Angela Mulcahy
 Ms. Tallie Eunice Murriel
 Ms. Jacquelyn Myers
 Mrs. Judy Myers
 Anni Niedermeyer
 Mrs. Sandra Ortwein
 Mr. Malcolm Parker
 Mrs. Trina Peters
 Mr. Michael Peters
 Mrs. Carol Polk
 Ms. Virginia Price
 Ms. Mary Randisi
 Mrs. Marty Reid
 Mrs. Stephanie Rich
 Mr. Jerry Roesler
 Mrs. Francine Sellinger
 Ms. Jane Seipp
 Mrs. Mary Jane Shorter
 Rev. Ernest Smart
 Ms. Janice Smart
 Mrs. Hilda Smith
 Mrs. Jean Smith
 Mr. Jack Smith
 Mrs. Judy Smith
 Mrs. Angie Sobo
 Mrs. Daisy Strasinger
 Mrs. Mae Strom

Ms. Midge Taylor
 Ms. Bobbi Trammell
 Ms. Sally Tullis
 Mrs. Faye Tully
 Mrs. Charlotte Turadian
 Ms. Marilyn Van Tassell
 Mr. Bill Wernecke
 Mr. Bill West
 Mr. Pete White
 Mrs. Joyce Wilhide
 Mr. Randy Wolford
 Mrs. Betty Lou Young
 Ms. Wilma Zimmerman

Pickersgill is also grateful to the many students who choose to volunteer at Pickersgill from schools, colleges and universities all over the Baltimore metro area. The following schools were represented in 2017:

Calvert Hall High School
 Gilman Boys School
 Loch Raven High School
 Loyola Blakefield High School
 Maryvale
 Notre Dame Prep
 St. Paul's School for Girls
 Towson University
 University of Maryland
 University of Maryland School of Pharmacy

Volunteer Clergy and Lay Ministers

The Rev. Joseph F. Barr
 Church of the Immaculate
 Conception
 Lay Minister Beulah Brown
 Faith Christian Fellowship
 Lay Minister Jack Danz
 Grace United Methodist
 The Rev. Garet Ellis
 First Luthern Church
 Lay Minister Richard
 Evans Church of the Immaculate
 Conception
 The Rev. Nick Ganas
 Timonium Presbyterian Church
 Lay Minister Lynn Lehneis
 Church of the Immaculate
 Conception

Lay Minister Judy Lichty
 Capitivate Christian Church
 The Rev. James McSavaney
 Grace United Methodist
 Lay Minister Eunice Murriel
 Faith Christian Fellowship
 Lay Minister Francine Sellinger
 Univ. of MD St. Joseph's Medical
 Center Chapel
 The Rev. Jessica Sexton
 Church of the Good Shepherd
 The Rev. Ernest Smart
 St. Andrew's Christian Community
 The Rev. Caroline Stewart
 Church of the Redeemer
 The Rev. Tally Wilgis
 Captivate Christian Church
 Faye Tully
 Music Ministry



Donor Report FY2018

Annual Report of Gifts from January 1, 2017 to December 31, 2017

Rendering of
proposed Sun Room



The Heritage Society: Leaving a Legacy

We are deeply grateful to those who have made the decision to include Pickersgill in their will or estate plan. Their thoughtfulness today provides for Pickersgill's tomorrow.

Listed below is a list of donors who left legacy gifts to Pickersgill.

Helen M. Alban	Raymond D. Miller Jr.
Margaret M. Cooper	Maurice M. Mitchell Jr.
Hally Brent Dame	Louise Sifford O'Connor
Alonzo G. and Virginia G. Decker	Robert E. Perkins
Edward B. Freeman	Rev. Douglas Pitt
Joseph L. Genner	Grace C. Tavenner
William M. Ginder	Agnes E. Tighe
Alexander Gordon IV	Donald Tucker
Alice E. Held	D'Arcy Hilles Gordon Young
Mary Johnson	
Catherine A. Lortz	

MARY PICKERSGILL SOCIETY - \$1,000 AND UP

Mrs. Karen Auwaerter
Mrs. Carlyle Barton Jr.
BB&T Corporation
Mr. Robert W. Bogue and Dr. Lauren Bogue
Mr. and Mrs. Brian W. Brooke
Mr. and Mrs. Charles W. Brooks Jr.
Ms. Mary Catherine Bunting
Mr. and Mrs. John B. Clough
Mrs. Gina Cooper
Mr. and Mrs. Robert Creager
Mr. and Mrs. Gordon Croft
Mrs. Worth B. Daniels Jr.
Mrs. Betty H. Dempster
Mr. and Mrs. P. Douglas Dollenberg
Mr. and Mrs. Barry Eisenberg
First Tennessee Foundation
Dr. and Mrs. Robert W. Flower
Mr. and Mrs. Raymond Giovannoni
Mr. and Mrs. H. Paul Heill
Ms. Ellen Hennessey

Mrs. Marilyn Melton
Mr. and Mrs. Michael A. Meredith
The Joseph Mullan Company
Ms. Jacquelyn Myers
PNC Bank
Remedi SeniorCare
Mr. Charles Sanborn
Mrs. Ellen Scurachio
Sodexo Senior Living
Mr. James Strom
Mrs. May Strom
Mr. and Mrs. Stephen Tully
Westfield Capital Management
Mr. and Mrs. Josiah J. Willard III
Mr. Charles W. Zimmerman
Ms. Wilma J. Zimmerman

STAR SPANGLED BANNER CLUB - \$500 TO \$999

Mrs. Rosemary Berry
Ms. Marsha Carroll
Mr. and Mrs. Dennis Finnegan

Mr. Richard C. Gamper
 Mr. and Mrs. James Gribbell, Jr.
 Mr. and Mrs. John Handley
 Mrs. Janice Harris
 Dr. and Mrs. Joseph Henry Hooper
 Mr. and Mrs. William H. Houpt
 Mrs. Reada Jasper
 Mr. and Mrs. Stanley J. Kraska
 Mr. and Mrs. William A. Mangels
 Mrs. Anni Niedermeyer
 Mrs. Sandra Ortwein
 Mr. and Mrs. Russell Purnell Rich
 Ms. Brenda May Richardson
 Mr. Wilfred J. Roesler

Mr. and Mrs. John Schenning
 Mr. and Mrs. John H. Strom
 Mr. and Mrs. James A. Ulmer III
 Mr. Patrick Worrall

BICENTENNIAL CLUB - \$200 TO \$499

Mrs. Jean Berg
 Bollinger Energy Corp.
 Mrs. Dorothy Boyce
 Mr. Walter Brewster
 Brightview Landscapes, LLC
 Mr. and Mrs. Richard Burch
 Mr. and Mrs. Steven Cline

Mrs. Margaret Eck
 Dr. and Mrs. Bob W. Gayler
 Dr. and Mrs. Clarence Gehris
 Mr. John Goodwin
 Greater Towson Council of
 Community Association
 Mr. Brant Hart
 Ms. Monica Hausner
 Mr. Brant Hart
 Mr. and Mrs. Douglas Hart
 Mrs. Lesley Horman
 Mrs. Violet Horman
 Mr. and Mrs. William F. Hunter Jr.
 Ms. Reada Jasper
 Mrs. Townsend Kent
 Ms. Judith Keys
 Mr. and Mrs. Kenneth Lew
 Mr. and Mrs. Craig Lewis
 Mr. and Mrs. Kenneth Lillquist
 Mr. and Mrs. Morgan Loane
 Mrs. Anita P. Logsdon
 Mrs. Sara Jane Nickels
 Mrs. Agnes Orem
 Mr. Charles F. Peace
 Mr. and Mrs. Stephen J. Phillips
 Pickersgill Apt. Residents' Assn.
 Mr. and Mrs. William J. Price
 Mr. and Mrs. Tate O. Redding
 Mr. Bruce Richards
 Mr. and Mrs. William Rinehart
 Mrs. Rita Schroeder
 Mr. and Mrs. Edward (Jack) Smith
 Mr. Larry Walker
 Mrs. Janet M. Wickens
 Woman's Club of Towson

PATRIOT CLUB - \$100 TO \$199

Mr. William Biehl
 Mr. John Bosley
 Mrs. Betsy Westervelt Bowen
 Mr. Martin S. Cassidy
 Mr. and Mrs. Jeffrey Chatham
 Mr. John Christopher
 Mr. Charles T. Cronin III
 Mr. John Decker
 Mr. Edward Dircks
 Mrs. Barbara Dowling
 Dr. Robert Duvall
 Mr. and Mrs. Daniel Ellis
 Mr. and Mrs. Burton English
 Ms. Mary Ellen Ensor
 Mr. and Mrs. Todd Evans
 Mr. and Mrs. Michael T. Fava
 Ms. Patricia A. Finnegan
 Ms. Carol R. Foglesong
 Ms. Gloria J. Francisco
 Mrs. Catherine Franey
 Ms. Esther Hall
 Mrs. Barbara Harant
 Ms. Claire Hartman
 Mr. and Mrs. William A. Hoyt
 Mr. and Mrs. Richard P. Howard
 Mr. and Mrs. Jay Hurd
 Mrs. Reada Jasper
 Mr. Richard Kaplan
 Hon. and Mrs. Dana Levitz
 Mrs. Carol Long - Mackay
 Mrs. Barbara K. Matheson
 Mrs. Dolores McClees





*Rendering of proposed
2nd Floor Corridor*

Mr. and Mrs. Peter McNamara
 Mrs. Sharon Molander
 Mrs. Dorothy Mooney
 Mrs. Maureen Murray
 Mrs. Ronald D. Nickles
 Mr. and Mrs. W. Walter Ortel
 Mr. Gordon Peltz
 Ms. Ida Poteet
 Mrs. Elizabeth Reese
 Mr. and Mrs. Charles Rittenhouse
 Mr. and Mrs. Albert Schnupp
 Mr. and Mrs. Andrew Shorter
 Ms. Mary Jane Shorter
 Mrs. Muriel Simon
 Mr. and Mrs. Ian Smith
 Mrs. Carole Sody
 Mrs. Daisy Strasinger
 Mr. and Mrs. Richard Suffredini
 Mr. Calvin Sweeten
 Mrs. Linda Taylor
 Mr. and Mrs. Myron E. Taylor
 Mr. Stephen Varanko

Ms. Terry Walter
 Mr. Douglas Warren
 Mr. Win Westervelt
 Mrs. Elizabeth Wheeler
 Mrs. Margaret Whitman
 Mr. and Mrs. Dorsey Yearly
 Mrs. Betty Lou Young

FRIENDS - UP TO \$99

Mrs. Beth Alder
 Mr. and Mrs. Daniel Babich
 Balto. Co. Employees Credit Union
 Mr. and Mrs. Jesse Bartley
 Mr. Paul Berry
 Mr. and Mrs. Harry Betsill
 Mr. and Mrs. William J. Blair
 Mr. and Mrs. John Bosley
 Mr. and Mrs. Richard Bradley
 Ms. Suzanne Brawley
 Mrs. Forrest Catron
 Mrs. Michelle Chatham
 Mrs. Rochelle Cohen

Mrs. Mary Pat Colianni
 Mr. and Mrs. Charles Cook
 Mr. and Mrs. Lingard Dircks
 Ms. Nancy Elson
 Ms. Ruth M. Fangman
 Mrs. Doris S. Fletcher
 Dr. and Mrs. Paul Gormley
 Mr. John F. Greene
 Mr. and Mrs. Frederick Griffith
 Ms. Elva M. Habicht
 Ms. Barbara Hamilton
 Mr. Charles Harlan
 Mrs. Jean Harrison
 Mr. and Mrs. W. Carl Hossfeld
 Mrs. Reada Jasper
 Mrs. Helen Kemp
 Dr. and Mrs. Thomas J. Kenny
 Mrs. Dusty Lidinsky
 Mrs. Loraine Lobe
 Mrs. Sandy Lynch
 Mr. James B. Martin
 Mrs. Karen Maylor

Mr. and Mrs. Charles B. Meyer
 Mr. and Mrs. George Miller
 Mrs. Margaret Miller
 Mr. Thomas Murray
 Mrs. Linda Myers
 Mrs. Doris Newell
 Mr. and Mrs. Patrick O'Connell
 Mr. and Mrs. Marvin L. Oed
 Mrs. Rebecca Orrick
 Mr. and Mrs. Edgar L. Pitman
 Mr. and Mrs. Doug Puls
 Mr. and Mrs. Richard L. Reid
 Mrs. Ann M. Remington
 Mrs. Adriane Rosenthal
 Mr. and Mrs. Thomas Schaefer
 Ms. Stephanie Seipp
 Mr. Robert Shaffer
 Mr. Lawrence P. Smith
 Mr. and Mrs. Ross Smith
 Mrs. Leigh Thomas
 Ms. Nancy Thompson
 Mr. Thomas Trapp

Ms. Courtney M. Ulmer
 Mrs. Dorothy Warfield
 Mrs. Mernie Weathers
 Mrs. Margaret Whitman
 Mrs. Carmen Wiessner
 Ms. Susan Wilhelm

THE BENEVOLENT CARE FUND

Mrs. Beth Alder
 Mr. and Mrs. Daniel Babich
 Balto. Co. Employees Federal Credit Union
 Mrs. Rosemary Berry
 Mr. and Mrs. Harry Betsill
 Mr. and Mrs. William J. Blair
 Mr. and Mrs. Richard Bradley
 Mr. and Mrs. Jeffery Chatham
 Ms. Michele Chatham
 Mr. John Christopher
 Mrs. Mary Pat L. Colianni
 Mr. and Mrs. Robert Creager



Mr. John Decker
 Mrs. Betty H. Dempster
 Mrs. Barbara Dowling
 Dr. Robert Duvall
 Mrs. Mary Ellen Ensor
 Ms. Patricia A. Finnegan
 Dr. and Mrs. Bob Gayler
 Mr. and Mrs. Raymond Giovannoni
 Mr. and Mrs. John F. Greene
 Mr. and Mrs. Frederick Griffith
 Ms. Elva M. Habicht
 Ms. Barbara Hamilton
 Mr. Brant Hart
 Mr. and Mrs. Paul Heill
 Mr. and Mrs. Richard P. Howard
 Mr. and Mrs. William F. Hunter
 Mrs. Reada Jasper
 Mr. Richard M. Kaplan
 Mr. and Mrs. Craig Lewis
 Mr. and Mrs. E. Morgan Loane
 Ms. Sandy Lynch
 Mr. and Mrs. William A. Mangels
 Mrs. Delores McClees
 Mr. and Mrs. Peter McNamara
 Mr. and Mrs. Charles B. Meyer
 Mr. and Mrs. George Miller
 Mrs. Margaret Miller
 Mrs. Dorothy Mooney
 Mr. and Mrs. Ronald D. Nickles
 Mrs. Sara Jane Nickles
 Mr. and Mrs. Marvin L. Oed
 Mrs. Agnes Orem
 Mr. and Mrs. Edmond B. Nolley, Jr.

Mrs. Mary Parr
 Mr. and Mrs. John Paull
 Pickersgill Apt. Residents' Assn.
 Mrs. Ida Poteet
 Mrs. Deborah Potter
 Mr. and Mrs. Doug Puls
 Mr. and Mrs. Wilfred J. Roesler
 Mr. Charles Sanborn
 Mr. and Mrs. John Schenning
 Mr. and Mrs. Albert Schnupp
 Mrs. Rita Schroeder
 Mrs. Ellen Scurachio
 Mrs. Stephanie Seipp
 Ms. Mary Jane Shorter
 Mrs. Muriel Simon
 Mr. and Mrs. Joseph W. Small
 Mr. and Mrs. Ross Smith
 Ms. Daisy Strasinger
 Mr. and Mrs. John Strom
 Mr. and Mrs. Richard Suffredini
 Mr. Scott Tate
 Mr. Joseph Tegeler
 Mrs. Nancy L. Thompson
 Mr. Thomas Trapp
 United Parcel Service
 Mr. Stephen Varanko
 Mr. and Mrs. William Wagner
 Mr. Larry Walker
 Ms. Terry Walter
 Mrs. Dorothy B. Warfield
 Mr. Dale Weammert
 Mrs. Janet M. Wickens
 Mr. and Mrs. George S. Wills

About The Benevolent Care Fund

The original charitable mission of Pickersgill Retirement Community when it was founded in 1802 is being fulfilled today, in large part, by The Benevolent Care Fund. While the majority of residents will never need this special fund, Benevolent Care offers security and peace of mind to those who do by bridging the gap and providing financial assistance when necessary on a case-by-case basis.





*Rendering of proposed
Multi-Purpose Indoor/Outdoor
Activity Space*



*We embarked on a multi-year community
design plan that will transform the majority of
our interior spaces as well as add new amenities.*

Woman's Club of Towson
Mrs. Patsy Woolridge
Mrs. Betty Lou Young
Mr. Charles W. Zimmerman
Ms. Wilma J. Zimmerman

THE ANNUAL FUND

Mrs. Karen Auwaerter
Mr. and Mrs. Jesse Bartley
Mrs. Carlyle Barton
Mr. W. Robert Benson
Mr. William Biehl
Mr. F. Barry Bilson
Mr. Robert W. Bogue and Dr. Lauren Bogue
Bollinger Energy Corporation
Mr. and Mrs. John D. Bosley
Mrs. Betsy Westervelt Bowen
Mrs. Dorothy Boyce
Mrs. Suzanne Brawley
Mr. Walter Brewster
Ms. Mary Catherine Bunting
Mr. and Mrs. Richard Burch
Mrs. Suzanne Burger
Ms. Marsha Carroll
Mr. Martin S. Cassidy
Mrs. Forrest Catron
Mrs. Patricia J. Clement
Mrs. Rochelle Cohen
Mrs. Gina Cooper
Mr. and Mrs. Robert Creager
Mr. and Mrs. Gordon Croft
Mrs. Worth B. Daniels Jr.
Mrs. Vivienne Derry
Mr. Edward Dircks

Mr. and Mrs. Lingard Dircks
Mrs. Rae Disney
Mrs. Margaret Eck
Mr. and Mrs. Daniel Ellis
Mrs. Nancy Elson
Mr. and Mrs. Burton English
Mrs. Gloria Epstein
Mr. and Mrs. Todd Evans
Mr. and Mrs. Michael T. Fava
Mr. and Mrs. Dennis Finnegan
First Tennessee Foundation
Mrs. Doris S. Fletcher
Dr. and Mrs. Robert W. Flower
Ms. Carol R. Foglesong
Mrs. Catherine Franey
Mr. Richard C. Gamper
Mr. John Goodwin
Dr. and Mrs. Paul Gormley
Greater Towson Council of Community Assoc.
Hamilton Insurance Agency
Mrs. Esther L. Hall
Mr. and Mrs. John Handley
Mrs. Barbara Harant
Mrs. Janice Harris
Mr. and Mrs. Douglas Hart
Mrs. Monica Hausner
Ms. Claire Hartman
Ms. Ellen Hennessey
Dr. and Mrs. Joseph Henry Hooper
Mrs. Lesley Horman
Mrs. Violet Horman
Mr. and Mrs. Carl W. Hossfeld
Mr. and Mrs. William A. Hoyt
Mr. and Mrs. Jay Hurd

Ms. Reada Jasper
The Joseph Mullan Company
Mrs. Helen Kemp
Dr. and Mrs. Thomas J. Kenny
Mrs. Townsend Kent
Mrs. Judith Keys
Hon. and Mrs. Dana Levitz
Mr. and Mrs. Frank G. Lidinsky
Mrs. Loraine Lobe
Mrs. Anita P. Logsdon
Mrs. Carol Long Mackay
Ms. Barbara Matheson
Mrs. Karen Maylor
Ms. Maureen Murray
Ms. Jacquelyn Myers
Mrs. Linda Myers
Mrs. Doris Newell
Mrs. Sara Jane Nickels
Mrs. Anni Niedermeyer
Mr. and Mrs. Patrick O'Connell
Mrs. Anni Niedermeyer
Mrs. Rebecca Orrick
Mr. and Mrs. W. Walter Ortel
Mrs. Sandra Ortwein
Mr. Gordon Peltz
Mr. & Mrs. Edgar L. Pitman
Mr. and Mrs. Richard L. Reid
Ms. Ann M. Remington
Mr. and Mrs. Russell Purnell Rich
Mr. and Mrs. Thomas Schaeffer
Mrs. Rita Schroeder
Mr. Robert Shaffer
Mr. and Mrs. Andrew Shorter
Mr. and Mrs. Edward (Jack) Smith
Mr. and Mrs. Ian Smith



About the Annual Fund

Contributions to this popular fund go directly toward what's needed most. All donations—unless otherwise specified—are directed toward The Annual Fund. The Annual Fund helps to support music programs, celebrations and special programs for residents. All gifts can be in memory or in honor of a family member or friend, and all gifts—regardless of size—make a difference!





About the Chapel Fund

Chapel Fund gifts go towards the renovation and upkeep of our Chapel which is the heart and soul of our community.



Mr. Lawrence P. Smith
Mrs. Carole Sody
Mr. James Strom
Mr. and Mrs. John Strom
Mrs. A. Mae Strom
Mr. and Mrs. Calvin W. Sweeten
Mrs. Leigh Thomas
Mr. Larry Walker
Mr. Douglas Warren
Mr. Win Westervelt
Westfield Capital Management
Mrs. Margaret Whitman
Mrs. Janet Wickens
Mr. and Mrs. Josiah J. Willard III
Mr. Patrick Worrall
Mr. and Mrs. Dorsey Yearley
Mr. Charles W. Zimmerman
Ms. Wilma J. Zimmerman

THE CHAPEL FUND

Mr. Brant Hart

GIFTS IN-KIND

American Visionary Arts Museum
Baltimore Museum of Industry
Baltimore Symphony Orchestra
Baltimore Tea and Coffee
Bluestone Restaurant
Chatty Crafters
Mr. & Mrs. Richard Davidson
Ms. Patricia Gates
Friendly Farms Restaurant
Dr. and Mrs. Frederick Gehris
Goetze Candy
Mr. and Mrs. Al Hayes

Mr. Charles Herndon
Ladew Gardens
Ms. Marilyn Melton
Maryland Historical Society
Michael's Cafe
Mr. & Mrs. Jack Moore
Ms. Jacque Myers
Ms. Eleanor Owens
Peppermill Restaurant
Mrs. Sara Riley
Radebaugh's Florist & Greenhouses
Mrs. Jane Seipp
Spa in the Valley
Systems Furniture Installations
The Turnover Shop

COUNTRY FAIR SPONSORS

BB&T Corporation
Bollinger Energy Corporation
Brightview Landscapes Inc.
Harlan/Barnes
PNC Bank
Remedi SeniorCare

Pickersgill Retirement Community contributed to the Benevolent Care Fund in memory of the following residents who died in 2017:

Eleanor Bannister
Catherine Carey
Jane Creager
Howard Dircks
Jeanne Disney

Margaret Edmonston
Dorothy Gerlach
Sandra Hedrick
Susanne Higinbotham
Ruth Howard
Lida King
Doris Klapp
Louis Knoedler
Florence MaHaffey
Eileen Maloney
Margaret McCleary
Alice McNamara
Samuel Mettee
William Norman
Ardis O'Connor
Barbara Polasik
Idell Purcell
Nancy Saunders
Marie Schlepner
Mary Schuhart
Nancy Shauck
Anne Shuman
Jane Stiffler
Emma Taylor
Catherine Wagner



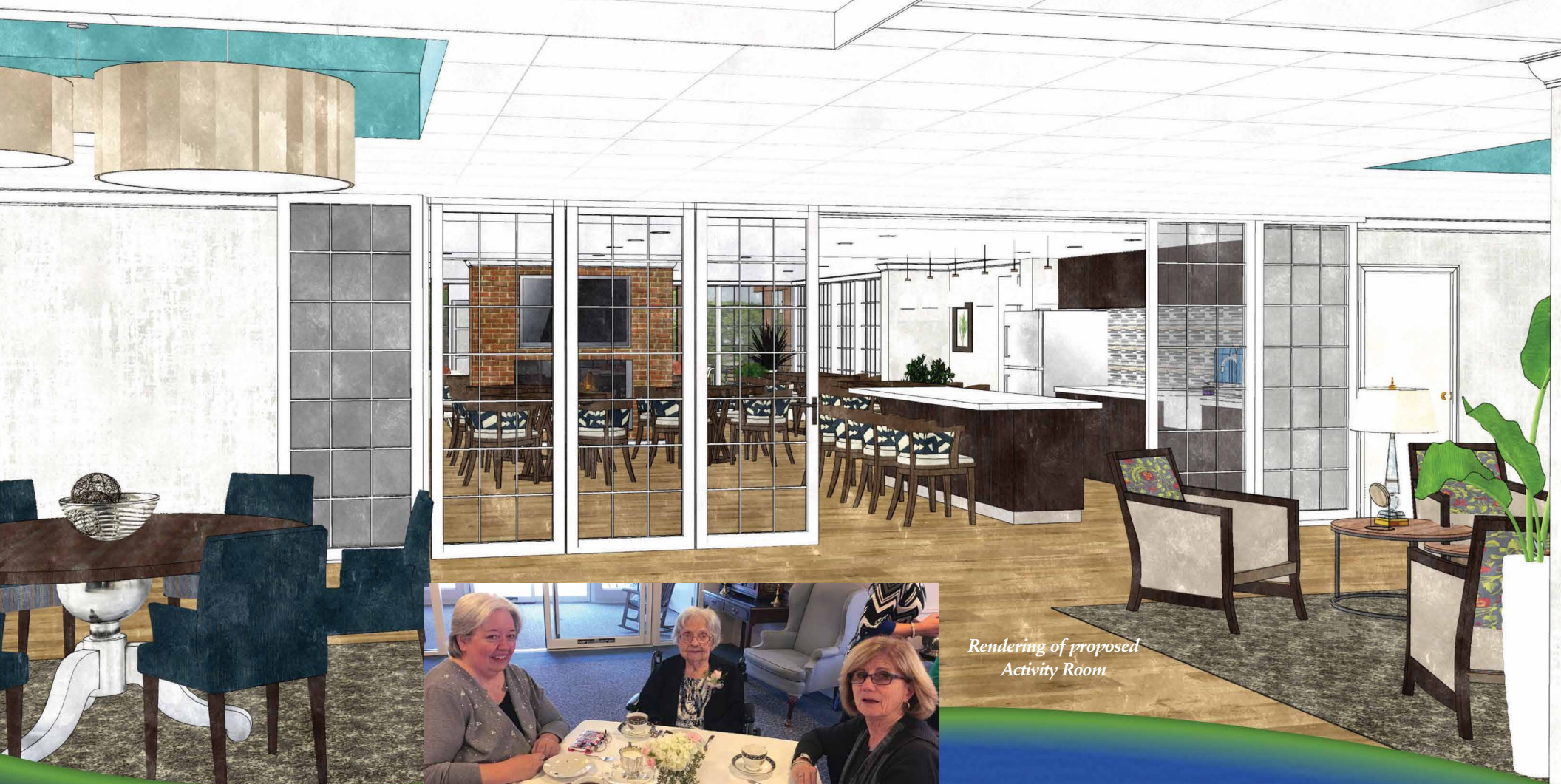

*Rendering of proposed
Activity Room*

*This ambitious project was started with
the sole purpose of improving the quality
of life of our residents.*





MEMORIALS

Elizabeth Bilson

Mr. F. Barry Bilson

Jean Bosley

Mr. and Mrs. John Bosley

Rose Carlino

Mr. Richard M. Kaplan

Mathilde Clark Holmes

Mr. and Mrs. William J. Price

William Crawford

Mr. Walter Brewster

Jane Creager

Mr. and Mrs. Robert Creager

Elizabeth Daunic

Mr. and Mrs. Richard P. Howard

Howard Dircks

Mr. and Mrs. Jesse Bartley

Mr. and Mrs. Robert Creager

Mr. Edward Dircks

Mr. and Mrs. Lingard Dircks

Mr. Robert Shaffer

Mr. and Mrs. Ian Smith

Mrs. A. Mae Strom

Mr. James Strom

Mr. and Mrs. John Strom

Marilyn Edick

Mrs. Forrest Catron

Mrs. Jacquelyn Myers

Helen Finnegan

Ms. Patricia A. Finnegan

Jean Fraunfelter

Mr. and Mrs. Harry E. Betsill

Charles and Jacqueline Gamper

Mr. Richard C. Gamper

Dorothy Gerlach

Mr. and Mrs. Daniel Babich

Balto. Co. Employees Federal Credit

Union

Mr. John Decker

Mrs. Delores McClees

Mrs. Margaret Miller

Mr. and Mrs. Ross Smith

Mr. Thomas Trapp

Webster Greenman

The Joseph Mullan Company

Harriet Greif

Mr. and Mrs. John Handley

Mr. and Mrs. John Schenning

Richard and Claire Hartman

Ms. Claire Hartman

Helen Hauser

Mr. Richard M. Kaplan

Ruth Howard

Mr. and Mrs. Richard Bradley

Majorie L. Jones

Mrs. Janet M. Wickens

Lida King

Mrs. Linda Myers

Hilda Jean Lewis

Mr. and Mrs. Patrick O'Connell

Helen Lindenstruth

Mrs. Agnes Orem

Regina Long

Mrs. Carol Long -Mackay

Joan Maloney

Mrs. Barbara Harant

Louise Sweeten McCain

Mr. and Mrs. Calvin W. Sweeten

Frances Meginnis

Mr. and Mrs. Burton English

Jennie Mills

Mr. and Mrs. Charles B. Meyer

Agnes Mitchell

Ms. Wilma J. Zimmerman

Marie Murray

Mrs. Catherine Franey

Ms. Maureen Murray

Marie Nickles

Mr. and Mrs. Ronald D. Nickles

Richard C. Nickels

Mrs. Sara Jane Nickels

Ernest Niedermeyer

Mrs. Anni Niedermeyer

Ardis O'Connor

Mr. and Mrs. Robert Creager

Mr. John F. Greene

Mrs. Dorothy Mooney

Mr. Thomas Murray

Mr. and Mrs. John Strom

Mr. Stephen Varanko

Woman's Club of Towson

Hortense Rene

Mrs. Carmen Wiessner

Dorothy Roesler

Mr. Wilfred J. Roesler

Mary Sappington

Mrs. Beth Alder

Mr. Patrick Worrall

Marie Schleupner

Mr. and Mrs. John Strom

Mary Schuhart

Mr. and Mrs. Daniel Ellis

Mr. and Mrs. Thomas Schaefer
Mrs. Leigh Thomas

Anne Schuman
Mrs. Ellen Scurachio

Eunice A. Sutton
Ms. Nancy Elson

Edythe Thompson
Mrs. Mary Pat L. Colianni
Ms. Nancy L. Thompson

Richard F. Warren
Mr. Douglas Warren

Harry Young
Betty Lou Young

Laura Zentz
Ms. Terry Walter

William Zimmerman
Mrs. Wilma J. Zimmerman

HONORARIUMS

Emma Chatham
Ms. Michelle Chatham

William Crawford
Mr. Walter Brewster

Kathy Kaylor
Mrs. Margaret Eck

Brigitte Henning
Mrs. Margaret Whitman

Bill and Susie Hunter
Mr. and Mrs. George S. Wills

Mary Hurd
Mr. and Mrs. Jay Hurd

Pickersgill Board of Directors
Mr. and Mrs. E. Morgan Loane

Brenda Richardson
Dr. and Mrs. Clarence Gehris
Ms. Gloria J. Francisco
Mr. Bruce Richards

Jane Seipp
Mrs. Stephanie Seipp

William and Mary Shock
Mr. John Christopher

Muriel Simon
Mr. and Mrs. Richard Suffredini

Jack and Jean Smith
Ms. Wilma Zimmerman

Mae Strom
Mr. James Strom

Mrs. Faye Tully
Hon. and Mrs. Dana Levitz

Wilma Zimmerman
Mr. and Mrs. Michael T. Fava
Ms. Carol R. Foglesong
Mr. and Mrs. Edgar L. Pitman
Ms. Ann M. Remington
Mr. Charles W. Zimmerman

THE NAMED FUND FOR THE ENDOWMENT

**Frances Deveas Albright
Endowment Fund**
Mr. and Mrs. Stanley J. Kraska

Rosemary Berry Endowment Fund
Mr. Paul Berry

What is the Named Fund for the Endowment?

A Named Fund for the Endowment is a way to honor a friend or loved one. A new fund is started with an initial gift of \$200 or more and then grows with additional donations made by family and friends. Any amount can be given at any time. As long as at least one gift of any amount is given each year, the fund will be recognized in our Annual Report.

Where does my gift go?

The purpose of an organization's endowment is to provide permanent financial support. Pickersgill's named funds become part of the principal of our endowment, which generates an income flow that's applied where needed, helping with critical needs such as benevolent care and our depreciation and replacement fund.

How can I start a Named Fund?

Contact the Development Office at 410-842-0421 or e-mail jstrom@pickersgillretirement.org.



Frances J. Brooks Endowment Fund
Mr. and Mrs. Charles W. Brooks Jr.

Rose Carlino Endowment Fund
Ms. Brenda May Richardson

Elizabeth Boyce Clough Endowment Fund
Mr. and Mrs. John B. Clough

R. Virginia Cronin Endowment Fund
Mr. Charles T. Cronin, III

Doris P. Dollenberg Endowment Fund
Mr. and Mrs. P. Douglas Dollenberg

Marilyn Beyerle Edick Endowment Fund
Ms. Jacquelyn Myers
Mrs. Linda Taylor

Hannah Young Fearson Endowment Fund
Mrs. Marilyn Melton

Mrs. Frank Lloyd Hammond Endowment Fund
Mr. and Mrs. Brian W. Brooke

Helen B. Hauser Endowment Fund
Ms. Gloria J. Francisco
Dr. and Mrs. Clarence Gehris
Mr. Bruce Eric Richards
Ms. Brenda May Richardson

Mathilde Clark Holmes Endowment Fund
Mr. and Mrs. William J. Price, V

Susie and Bill Hunter Endowment Fund
Mr. Charles Cook
Mr. and Mrs. George S. Wills

James and Audrey Kane Endowment Fund
Mrs. Sharon Molander

Ruth Lemkau Endowment Fund
Mr. and Mrs. William H. Houpt
Ms. Elizabeth Wheeler

Anna May Lew Endowment Fund
Mr. and Mrs. Kenneth Lew

Ruth C. Martin Endowment Fund
Ms. Ruth M. Fangman
Mr. James B. Martin

Theresa E. McCarthy Endowment Fund
Ms. Courtney M. Ulmer
Mr. and Mrs. James A. Ulmer III

Doris Wetmore Morgan Endowment Fund
Mr. and Mrs. Charles W. Morgan

Lawrence G. Myers and Thelma D Endowment Fund
Ms. Jacquelyn Myers

Ann Louise Thomas Peace Endowment Fund
Mr. and Mrs. Thomas Peace
Mr. Charles F. Peace, IV

Elizabeth T. Pick Endowment Fund
Mr. and Mrs. Myron E. Taylor

Dolores J. Redding Endowment Fund
Mr. and Mrs. Tate O. Redding

G. Robert Reese Endowment Fund
Mrs. Jean Berg
Mrs. Margaret Eck
Mrs. Elizabeth Reese

Hortense Rene Endowment Fund
Mr. and Mrs. James F. Gribbell Jr.
Mrs. Carmen Wiessner

Olive S. Rinehart Endowment Fund
Ms. Marcia L. Conlin
Mr. and Mrs. Kenneth Lillquist
Mr. Phillip Lillquist
Mr. and Mrs. William Rinehart

Jean Smith Endowment Fund
Mr. and Mrs. Edward (Jack) Smith

Eugene and Norma Struckhoff Endowment Fund
Mr. and Mrs. Steven Cline

Dorsey Yearley Endowment Fund
Mr. and Mrs. Michael A. Meredith
D'Arcy Hilles Gordon Young Endowment Fund
Mr. and Mrs. Stephen J. Phillips

Wilma Zimmerman
Mr. Charles W. Zimmerman
Mr. and Mrs. Michael T. fava
Ms. Ann M. Remington

Eva Zumbrun Endowment Fund
Ms. Brenda May Richardson





About Us



Mary Young Pickersgill,
1776 – 1857



The Star-Spangled Banner. Photo courtesy of Smithsonian Institute. Flag can be viewed at the National Museum of American History. americanhistory.si.edu

A Rich History: Serving Seniors for more than Two Centuries

Founded as a charitable organization in 1802, Pickersgill Retirement Community is named after one of the organization's early leaders, Mary Young Pickersgill, the Baltimore flagmaker who sewed the flag that flew over Fort McHenry during the War of 1812 that inspired Francis Scott Key to write our national anthem, "The Star-Spangled Banner."

Today, the nonprofit, nondenominational, independently owned and managed retirement community offers seniors a comfortable retirement lifestyle with a variety of independent living, assisted living and skilled nursing care accommodations.

OVERVIEW:

- Nonprofit, nondenominational, independently owned and managed
- Continuous care retirement community
- 216 years old (since 1802)
- Maryland's oldest retirement community

RESIDENTIAL LIVING:

- Serving approximately 270 residents
- 138 Assisted Living rooms and suites
- 87 Independent Living apartments
- 35 Skilled Nursing Care rooms

FEES:

- No entrance fee
- Call for monthly fees

LOCATION:

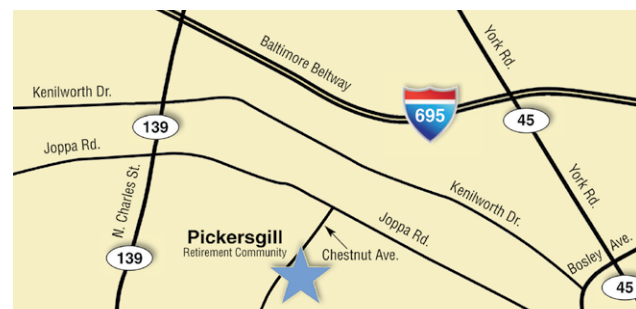

SITE SIZE:

- 16 acres, including well-landscaped grounds

AMENITIES:

- Spacious assisted living rooms and suites with kitchenettes and private baths
- Formal dining rooms
- Casual dining café
- Walking paths
- Chapel/Meditation room
- Libraries
- Auditorium
- Convenience store
- Computer lab
- Beauty and barber shop
- And more



615 Chestnut Avenue • Towson, Maryland 21204

www.PickersgillRetirement.org
(p) 410-825-7423 • (f) 410-821-6275

Non Profit Org
US
Postage
Paid
Towson, MD
Permit #6897

